



SAN JOAQUIN DELTA COLLEGE

# Manteca Campus Master Planning Progress Report

August 14, 2007



SAN JOAQUIN DELTA COLLEGE



Satellite Photo  
Manteca Campus  
Delta Community College

From : Terraserver

Highway 99



# SAN JOAQUIN DELTA COLLEGE

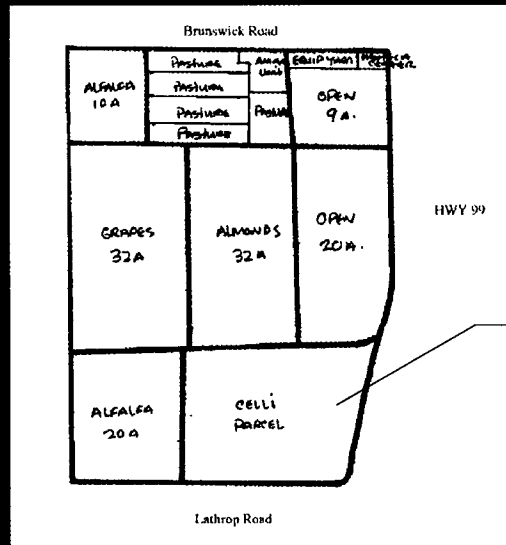

Current  
Land  
Use  
Schematic

Not part  
of Delta  
College



# SAN JOAQUIN DELTA COLLEGE

## Steering Committee Findings

### General Education:

- Serve a growing student population as Manteca grows from 60,000 to 100,000 residents.
- Potential for growth: Business needs our students.
- Community resource



## SAN JOAQUIN DELTA COLLEGE

### Steering Committee Findings

#### Heavy Equipment Maintenance:

- Existing program uses 21,985 ASF (approximately 27,161 GSF).
- Ideal Heavy Equipment program would have 42,000 GSF Lab and 15,000 GSF classroom.
- Ideal program provides for more fte, wider range of classes.
- Could share General Education space for classrooms, computer labs, support space.
- Substantial outdoor space required for operations, logistics.



## SAN JOAQUIN DELTA COLLEGE

### Steering Committee Findings

#### Heavy Equipment Maintenance:

- Costs could range from \$19M for base facility to \$28M for full program build out.
- Move would free up space at Stockton campus
- Use is compatible with Manteca property
- Potential for partnerships : CAT and other heavy equipment maintenance organizations.



SAN JOAQUIN DELTA COLLEGE

## Steering Committee Findings

### Agricultural Program

- Small student population, unique resource.
- Address health and safety issues for continued operations.
- Crops/small animals.
- Some income from Almonds, etc.
- Some potential for partnerships.



SAN JOAQUIN DELTA COLLEGE



Manteca Farm North East Corner : Proposed development area



# SAN JOAQUIN DELTA COLLEGE



Existing Classroom Building



# SAN JOAQUIN DELTA COLLEGE

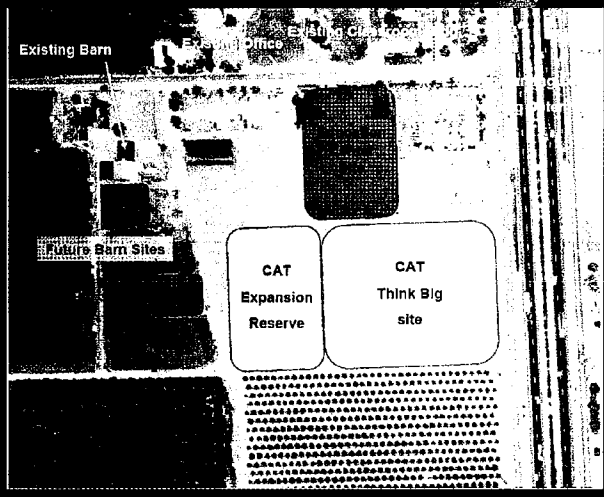

Layout sketch showing approximate size of various potential program elements: this layout is for discussion only



SAN JOAQUIN DELTA COLLEGE

### Required Infrastructure

#### Water

- Potable water
- Fire hydrants
- Fire sprinklers

#### Storm Drain

- New impervious area
- SSJID may help

#### Sanitary Sewer

- New capacity nearby
- City of Manteca system

#### Electricity

- Available NE corner

#### Access

- Already in place; improvements needed

#### Boundary delineation/control

- Good fences = good neighbors



SAN JOAQUIN DELTA COLLEGE

### Annexation Actions

- Service analysis
- Cost, capacity, feasibility
- Districts joined and separated
- City of Manteca
- CEQA
- Legal work
- LAFCO



SAN JOAQUIN DELTA COLLEGE

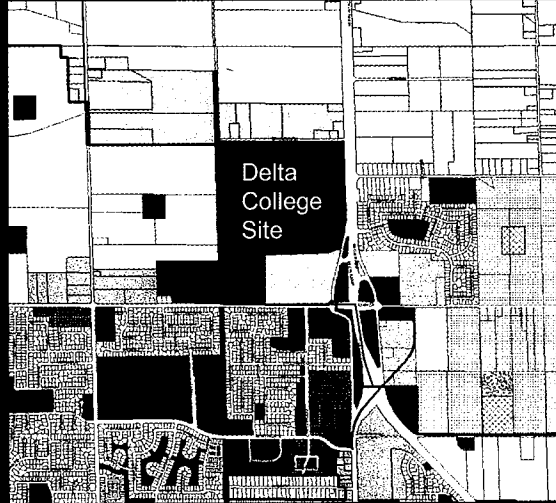

City of Manteca

General Plan

June 2006

Delta College may want to consider annexation to City of Manteca so that city services become available to the campus : sewer, water, etc.



SAN JOAQUIN DELTA COLLEGE



Project:  
New  
Housing

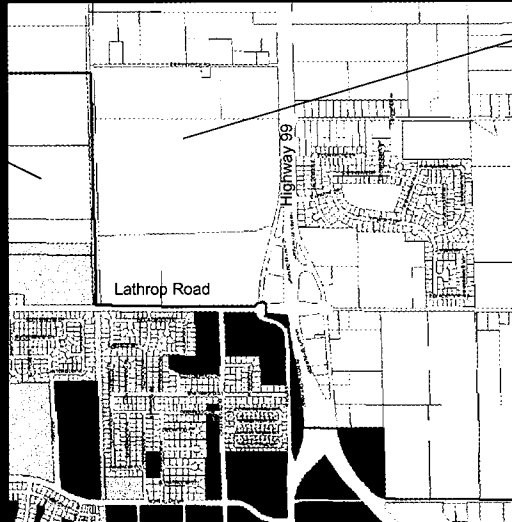

Delta College  
Manteca Site

City of Manteca

Zoning Map

June 2006



## SAN JOAQUIN DELTA COLLEGE

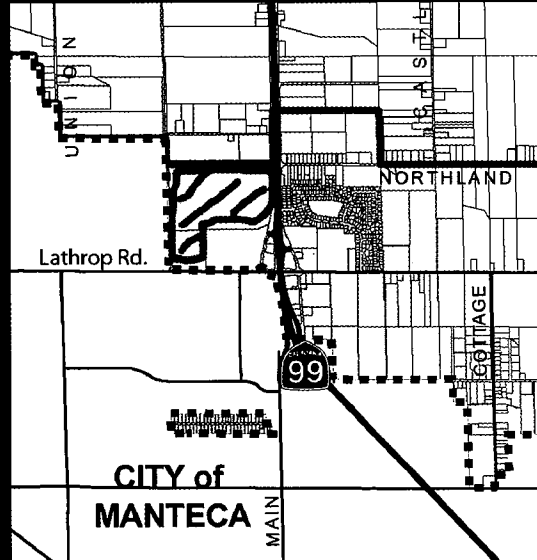

LAFCO City of Manteca  
Sphere of Influence Map

Delta College Site shown  
in green hatching.



## SAN JOAQUIN DELTA COLLEGE

### CEQA Process

- Initial Geotech studies this phase
- Leverage studies done for Union Ranch
- Program level EIR: Focus on NE Corner
- Required for Master Plan and Annexation
- Preliminary evaluation



SAN JOAQUIN DELTA COLLEGE

**Next Steps :**

- Explore partnership opportunities
- Begin CEQA process
- Begin Annexation
- Explore feasibility of capital financing, including possible "lease-leaseback"